

Data

Permissible bending of lower control arm (measured along the longitudinal vehicle axle)	1.5 ¹⁾
Permissible bending of ball pin for supporting joint	0.5

1) Bending value is within permissible limits when checking bolt can be inserted.

Special tools

Device for checking lower control arm	115 589 12 23 00
---------------------------------------	------------------

Commercially available tools

Measuring stand	e.g. Messrs. Bosch, Stgt.-Feuerbach Order No. 0601 980 001
Dial gauge A1 DIN 878	e.g. Messrs. Mahr, Esslingen Order No. 810 St

1 To check for bending and non-parallelity, place the complete control arm with rubber mounts in the special device (63) (Fig. 1).

2 Check non-parallelity with rule (63a).

3 Insert checking bolt (63b). If the bolt cannot be inserted, the permissible bending amount has been exceeded.

4 To check the ball pin for bending, insert receiving ring into the chuck of a lathe.

Receiving ring self-made according to Fig. 2.

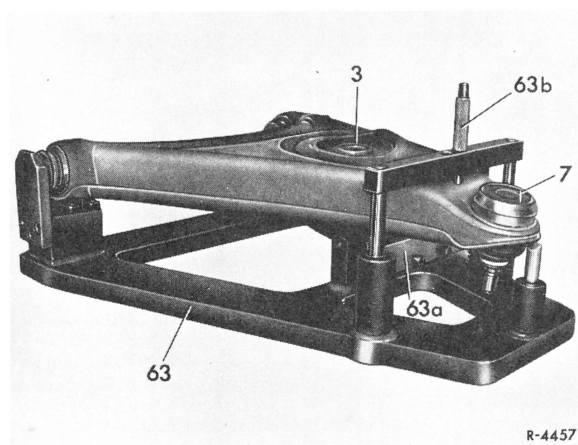

Fig. 1

- | | |
|---------------------|---------------------------------------|
| 3 Lower control arm | 63a Rule for checking non-parallelity |
| 7 Supporting joint | 63b Bolt for checking bending |
| 63 Special device | |

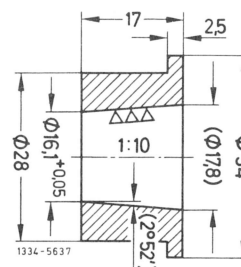

Fig. 2

5 Insert ball pin into receiving ring and press in.

33.1 Check lower control arm

6 Attach dial gauge to the reinforcing ring of the control arm with 1 mm pretension and measure bending of the ball pin at approx. 25/min (Fig. 3).

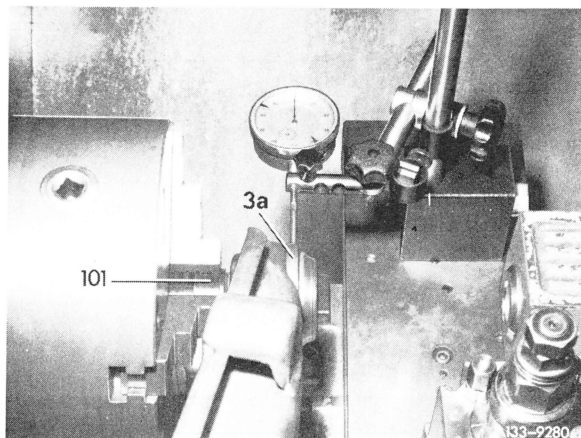

Fig. 3

3a Reinforcing ring on lower control arm
101 Receiving ring